



To keep staff and clients safe, the following procedures will be in place as of June 1, 2020. Anyone violating these procedures will immediately be asked to adhere to the guidelines. If they continue to disregard procedures, they will be asked to leave the building.

1. Slots are now booked 20 minutes apart to allow time for all players on the sheet to vacate the building. Cleaning of the facility per the CDC recommendations will take place at this time
2. Each ice sheet will be limited to 10 people
3. Social distancing (6 feet) must be kept at all times. **NO INTERMINGLING OF GROUPS IS ALLOWED**
4. To minimize contact, renters will be assigned specific doors to enter and exit the building.
Coaches will be required to convey this information to their skaters
5. Parents will not be allowed in the building. They may wait in their cars. **NO GATHERINGS IN THE LOT WILL BE PERMITTED**
6. Coaches and players must come fully dressed with skate guards on
7. Rest rooms will only be available on an emergency basis. No water fountains will be available
8. Coaches and players must go directly onto the ice upon entry
9. Coaches and players must immediately exit the ice when their time slot expires
10. Face shields, in lieu of cages, are highly recommended
11. Coaches are ***required to submit completed waivers*** for themselves and each of their clients prior to entering the ice

Continued....

Rink information:

NHL 1 Rink Entry/Exit Procedure

Coaches and skaters will enter the building through the main entry **Yellow Door 1 on the North side of the building**. All coaches and skaters should enter the building dressed, with skate guards on and go directly onto the ice. Parents are not allowed in the building.

Coaches and skaters will exit through the **Yellow Exit Door 1 on the West side of the building** immediately upon their time expiring so cleaning can be completed.

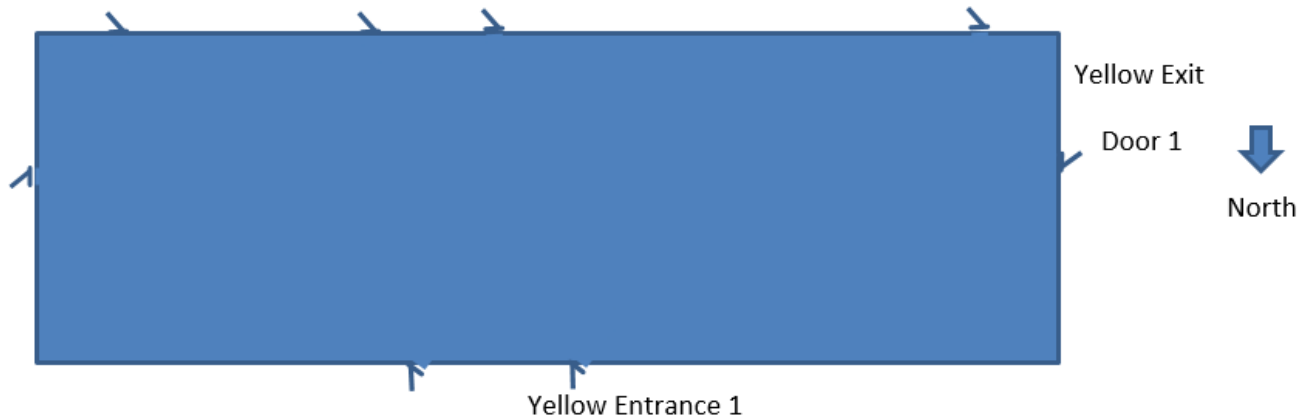

NHL 2 Rink Entry/Exit Procedure

Coaches and skaters will enter the building through the **Orange Door 2 on the North side of the building**. All coaches and skaters should enter the building dressed, with skate guards on and go directly onto the ice. Parents are not allowed in the building.

Coaches and skaters will exit through the **Orange Exit Door 2 on the East side of the building**. Coaches and skaters must immediately leave the building upon their time expiring so cleaning can be completed.

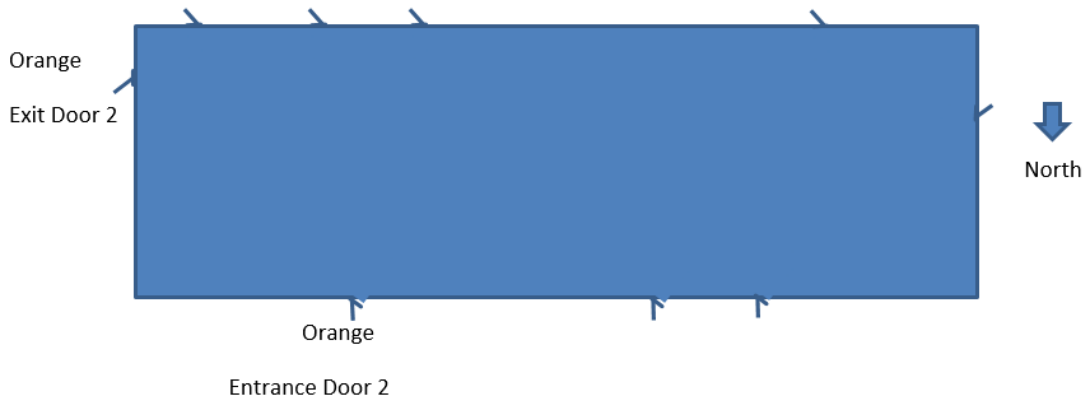

Skills Rink Entry/Exit Procedure

Coaches and skaters will enter the building through the **Blue Door 3 on the South side of the building.** All coaches and skaters should enter the building dressed, with skate guards on and go directly onto the ice. Parents are not allowed in the building.

Coaches and skaters will exit through the **Blue Exit Door 3 on the South side of the building.** Coaches and skaters must immediately leave the building upon their time expiring so cleaning can be completed.

Goalies will enter and exit the building through the **Blue Goalie Door on the South side of the building.**

