

Assigning Guardians

Spouses & other family members of an athlete can be added as "Guardians" to view the team schedule, RSVP to games and events, message team members, and edit the athlete's profile.

- On a computer: Head to hockey club website and log in, access your account by clicking your initials in the blue circle in upper-right. Select SETTINGS area. **Go to your Profiles tab.**

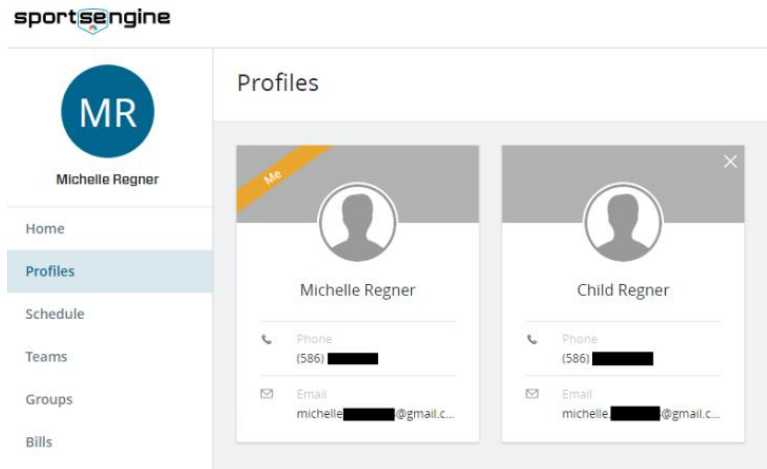

- Click on an athlete sub profile. (NOTE: You cannot add a Guardian to the account owner's profile.)
- If you don't have a sub profile for the athlete, you will need to add one either through a registration or by claiming a roster spot.
- On the right side, click the plus sign (+) to add a Guardian.

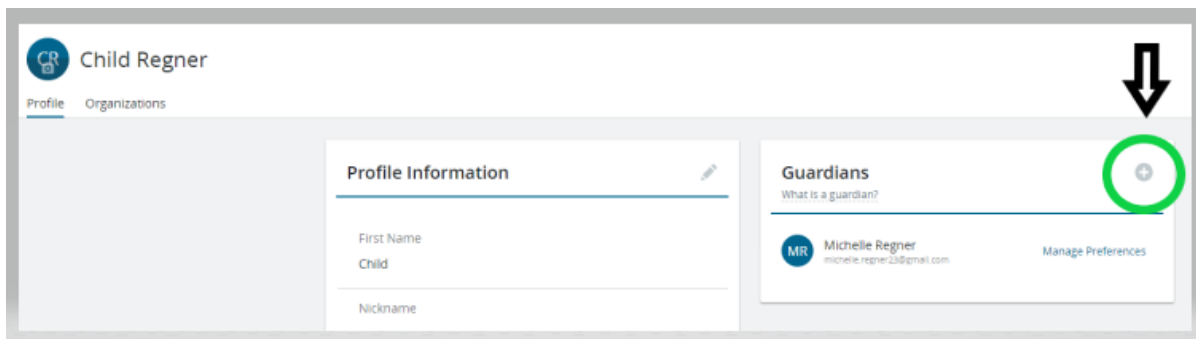

- Input the Guardian's email address to invite them. (Toggle which athlete profiles this Guardian should manage.)
- Click Send Invitation.

Invite a Guardian

Invite:

Invite this guardian to manage the following profiles:

Child Regner

Adding Guardian on the SportsEngine App

Login to SportEngine app using the same email and password combination you use on the Rochester Hockey Club website. Once logged in you will see your options **along the bottom** – **click on ACCOUNT** – and **select child's sub profile**. Once in Child's profile, locate guardians tab in the upper right and **click on Blue + in bottom right**.

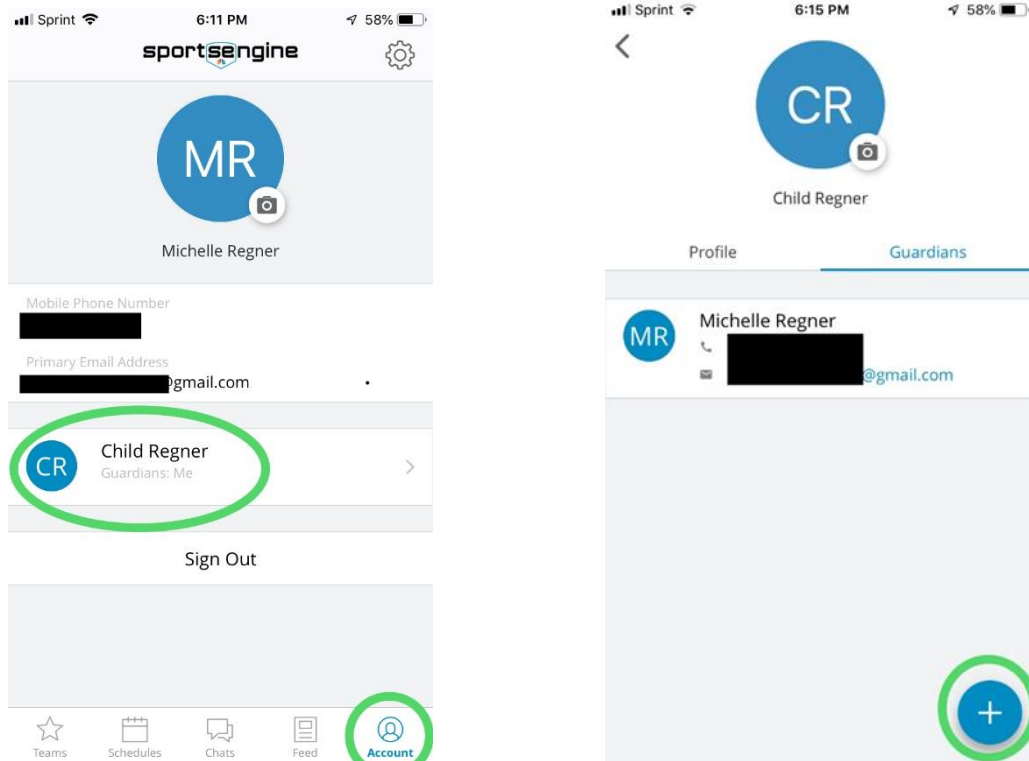

- Input the Guardian's email address to invite them. (Toggle which athlete profiles this Guardian should manage.)
- Click SAVE.

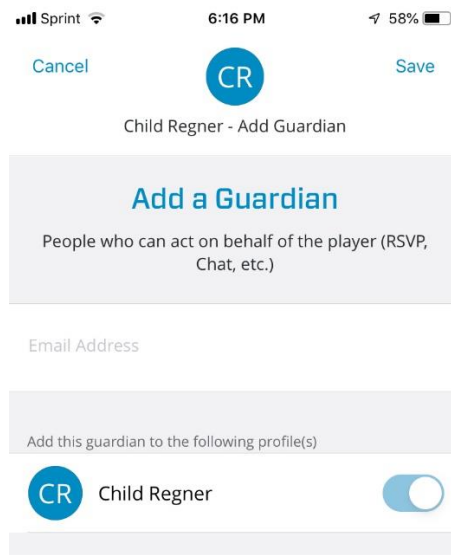

Helpful Tip! The invited guardian will appear on the Guardians tab as "Pending" until they create an account in SportsEngine and accept their invite in their Dashboard. You can resend a guardian invite at any time by tapping Resend next to the Guardian's name. You will receive an email when the Guardian has accepted the invite.